

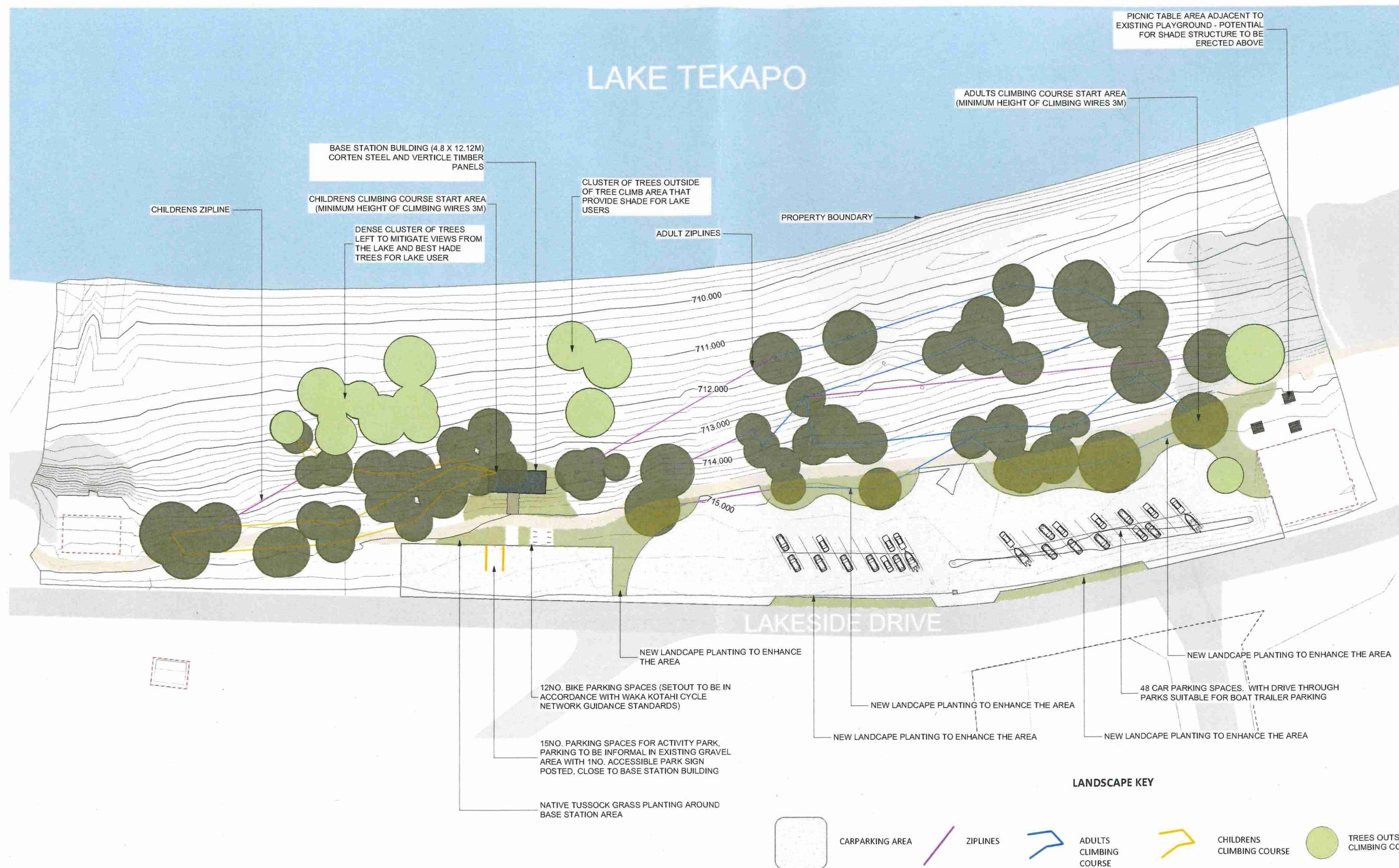

# LAKE TEKAPO



PICNIC TABLE AREA ADJACENT TO EXISTING PLAYGROUND - POTENTIAL FOR SHADE STRUCTURE TO BE ERECTED ABOVE

ADULTS CLIMBING COURSE START AREA (MINIMUM HEIGHT OF CLIMBING WIRES 3M)

BASE STATION BUILDING (4.8 X 12.12M) CORTEN STEEL AND VERTICLE TIMBER PANELS

CHILDRENS CLIMBING COURSE START AREA (MINIMUM HEIGHT OF CLIMBING WIRES 3M)

CLUSTER OF TREES OUTSIDE OF TREE CLIMB AREA THAT PROVIDE SHADE FOR LAKE USERS

CHILDRENS ZIPLINE

DENSE CLUSTER OF TREES LEFT TO MITIGATE VIEWS FROM THE LAKE AND BEST HADE TREES FOR LAKE USER

ADULT ZIPLINES

PROPERTY BOUNDARY

710.000

711.000

712.000

713.000

714.000

715.000

LAKESIDE DRIVE

NEW LANDCAPE PLANTING TO ENHANCE THE AREA

12NO. BIKE PARKING SPACES (SETOUT TO BE IN ACCORDANCE WITH WAKA KOTAHU CYCLE NETWORK GUIDANCE STANDARDS)

15NO. PARKING SPACES FOR ACTIVITY PARK, PARKING TO BE INFORMAL IN EXISTING GRAVEL AREA WITH 1NO. ACCESSIBLE PARK SIGN POSTED, CLOSE TO BASE STATION BUILDING

NATIVE TUSSOCK GRASS PLANTING AROUND BASE STATION AREA

NEW LANDCAPE PLANTING TO ENHANCE THE AREA





NEW LANDCAPE PLANTING TO ENHANCE THE AREA

48 CAR PARKING SPACES. WITH DRIVE THROUGH PARKS SUITABLE FOR BOAT TRAILER PARKING

NEW LANDCAPE PLANTING TO ENHANCE THE AREA

NEW LANDCAPE PLANTING TO ENHANCE THE AREA

### LANDSCAPE KEY

-  CARPARKING AREA
-  ZIPLINES
-  ADULTS CLIMBING COURSE
-  CHILDRENS CLIMBING COURSE
-  TREES OUTSIDE OF TREE CLIMBING COURSE

Landscape Design & Construction t 022 199 1944 w www.dwg.co.nz p 2/14 Gerald Street, Lincoln	<b>REVISIONS</b> DATE    REV    DESCRIPTION		PROJECT TITLE <b>Lake Tekapo Tree Climb Lake Tekapo</b>	DRAWING TITLE <b>OPTIONAL COUNCIL DEVELOPMENT LANDSCAPE PLAN</b>	SCALE 1:400 @ A1 & 1:800 @ A3	DESIGNED CS / JW	 LANDSCAPE ARCHITECTURE & OUTDOOR KITCHENS
	STAGE Concept	DATE 14.06.2024	DRAWN CS	JOB NO. 2308	DWG NO. SIT_002	REV	